



REF: # 6037

FINESTRAT



INFO

PRICE:	540.000 €
PROPERTY TYPE:	Villa
CITY:	Finestrat
BEDROOMS:	4
Bathrooms:	2
Build (m2):	298
Plot (m2):	534
Terrace (m2):	150+85
Year:	2018
Floor:	-
Old price	-



DESCRIPTION

New villa project under construction and consists of a group of houses, each of them on two levels, full of light. They enjoy above all huge communal spaces at different heights with swimming pools, children's play area, paper courts, Social Beach Club, gym. The project is located on the Avenida de América of Sierra Cortina: Asia Gardens Hotel, golf courses, Villa Aitana Hotel, Terra Mitica Theme Park ... The avenue is connected directly to the exit of the AP-7 La Marina, Crossroads, Leroy Merlin, Mercadona, Decathlon, etc. And next to this all the services of the most powerful tourist center of the Costa Blanca. Unique villas The views, the design, the luminosity, the qualities ... create with this project a unique space to experience the Mediterranean. Villa Esmeralda has a more horizontal design. On the main floor are the living rooms and kitchen, as well as the bedrooms. In this type of villa the pool is projected on the upper floor, on a solarium, conforming a creative design and offering spectacular views from the pool itself. There is also the possibility of placing the pool in the garden.

ENERGETIC CERTIFIED



STYLE	VIEWS	AIRCONDITIONING	DISTANCE TO :
<ul style="list-style-type: none">• Modern	<ul style="list-style-type: none">• Panoramic views• Sea views• Mountain views	<ul style="list-style-type: none">• Central airconditioning	Beach : 4 Km Airport: 50 Km Town center : 5 Km
ORIENTATION	PARKING	MAIN LIVING AREA	FLOORING
South	Parking no Cars: 1	<ul style="list-style-type: none">• Bathroom en-suite	<ul style="list-style-type: none">• Tile floors• Laminate floors
KITCHEN	GARDEN AND TERRACES	HEATING	EXTRA
<ul style="list-style-type: none">• Open kitchen• Equipped kitchen	<ul style="list-style-type: none">• Covered terrace• Open terrace• Exterior lights• Palm trees• Fenced• Private garden• Communal Garden	<ul style="list-style-type: none">• Central electric heating	<ul style="list-style-type: none">• Built in wardrobes• Door bell with camera

PROPERTY GALLERY

















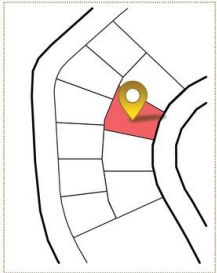

*Las imágenes iconográficas contenidos en esta publicación son orientativas, no contractuales y están sujetas a modificación de proyecto. This is non-contractual document. The imperative determinations of the executive project can change.

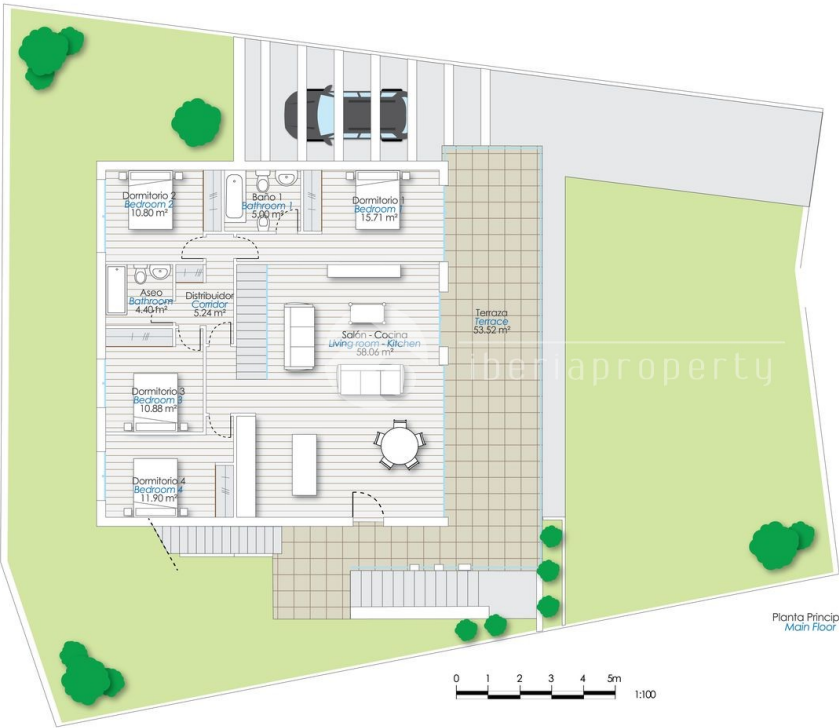

Planta Principal	138.60 M²
Main Floor	
Entrepanta	159.10 M²
Down Floor	
Terrazas	85.36 M²
Terraces	
Solarium	150.50 M²
Solarium	
Superficie Total	533.56 M²
Construida	
Total Built Area	
Piscina	31.50 M²
Pool	
Parcela Aprox	524.00 M²
Aprox Plot	

*Las imágenes iconográficas contenidos en esta publicación son orientativas, no contractuales y están sujetas a modificación de proyecto. This is non-contractual document. The imperative determinations of the executive project can change.

TU CASA, TU VIDA

VILLA ESMERALDA 1

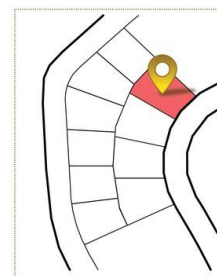
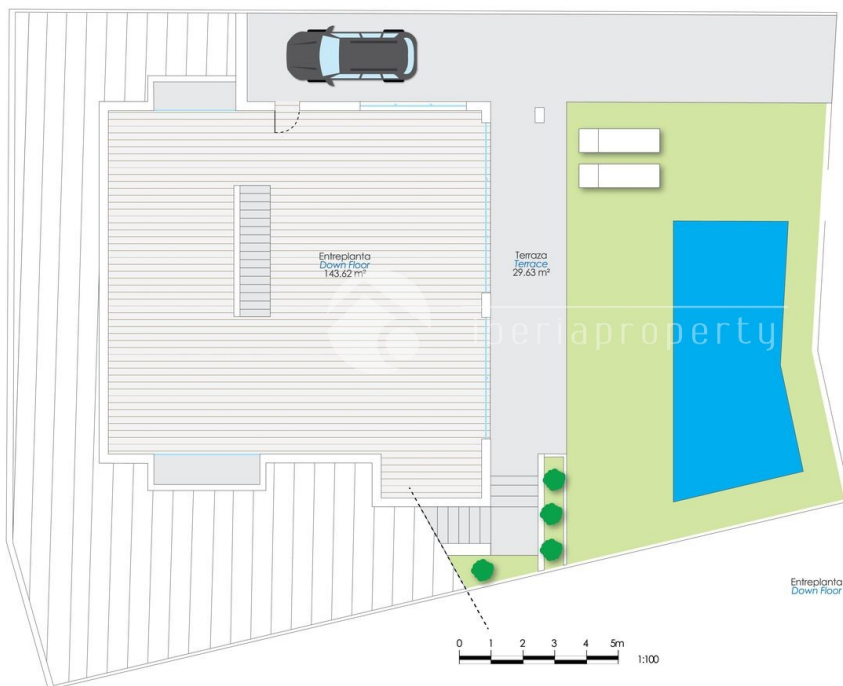

*Las imágenes iconográficas contenidos en esta publicación son orientativas, no contractuales y están sujetas a modificación de proyecto. This is non-contractual document. The imperative determinations of the executive project can change.

TU CASA, TU VIDA

VILLA ESMERALDA 1

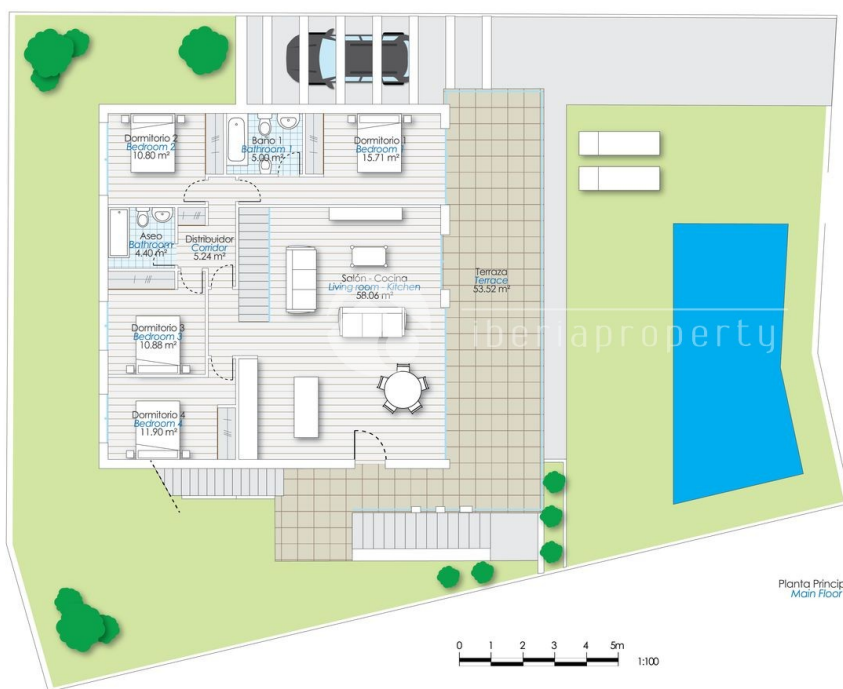

Planta Principal	138.60 M ²
Main Floor	
Entrepanta	159.10 M ²
Down Floor	
Terrazas	85.36 M ²
Terraces	
Solarium	150.50 M ²
Solarium	

Superficie Total	533.56 M ²
Construida	
Total Built Area	

Piscina	33.00 M ²
Pool	
Parcela Aprox	524.00 M ²
Aprox Plot	

*Las imágenes iconográficas contenidos en esta publicación son orientativas, no contractuales y están sujetas a modificación de proyecto. This is non-contractual document. The imperative determinations of the executive project can change.

"OUR EXPERIENCE IS YOUR GUARANTEE"