



REF: # 4547

LA NUCIA/POLOP (LA NUCIA CENTRO)



#### INFO

PRICE:	149.000 €
PROPERTY TYPE:	Villa
CITY:	La Nucia/Polop (La Nucia Centro)
BEDROOMS:	1
Bathrooms:	1
Build ( m2 ):	70
Plot ( m2 ):	1.800
Terrace ( m2 ):	60
Year:	
Floor:	1
Old price	-



#### DESCRIPTION

Countryside villa with mountain views. It has 1800m of fenced land with fruit trees and natural grass. Sun all day and very private. Walking distance to La Nucia center. Livingroom with fireplace, new open citchen, all very bright. Bathroom with shower in new style. Southfacing terrace, barbeque area. Reacently big reforms, new doble glased windows, insulation in flloor, walls and roof. Floor heating and aircondition heatpump. New gate parking for 3 cars inside the plot

#### ENERGETIC CERTIFIED



<b>STYLE</b>	<b>AIRCONDITIONING</b>	<b>DISTANCE TO :</b>	<b>ORIENTATION</b>
<ul style="list-style-type: none"><li>Contemporary</li></ul>	<ul style="list-style-type: none"><li>Livingroom</li><li>Kitchen</li></ul>	Beach : 5 Km Airport: 60 Km Town center : 1 Km	South
<b>FURNITURE</b>	<b>PARKING</b>	<b>TAX</b>	<b>FLOORING</b>
<ul style="list-style-type: none"><li>Not furnished</li></ul>	Parking no Cars: 3	I.B.I : 181 €	<ul style="list-style-type: none"><li>Tile floors</li></ul>
<b>KITCHEN</b>	<b>GARDEN AND TERRACES</b>	<b>HEATING</b>	<b>EXTRA</b>
<ul style="list-style-type: none"><li>Open kitchen</li><li>Equipped kitchen</li></ul>	<ul style="list-style-type: none"><li>Open terrace</li><li>Fruit trees</li><li>Palm trees</li><li>Landscaped</li><li>Fenced</li><li>Lawn</li><li>Stone walls</li><li>BBQ/grill</li><li>Private garden</li></ul>	<ul style="list-style-type: none"><li>Floor heating</li><li>Floor heating bathrooms</li><li>Fireplace wood</li></ul>	<ul style="list-style-type: none"><li>Reinforced door</li><li>Double glazed windows</li><li>Satellite TV</li><li>Internet</li></ul>























COLEGIO OFICIAL DE APAREJADORES, ARQUITECTOS TÉCNICOS  
E INGENIEROS DE EDIFICACIÓN DE ALICANTE

10-08930

**VISADO**

02291 JOSE CHACON MESA

El colegio garantiza la firma digital de este documento

Página 1 de 1

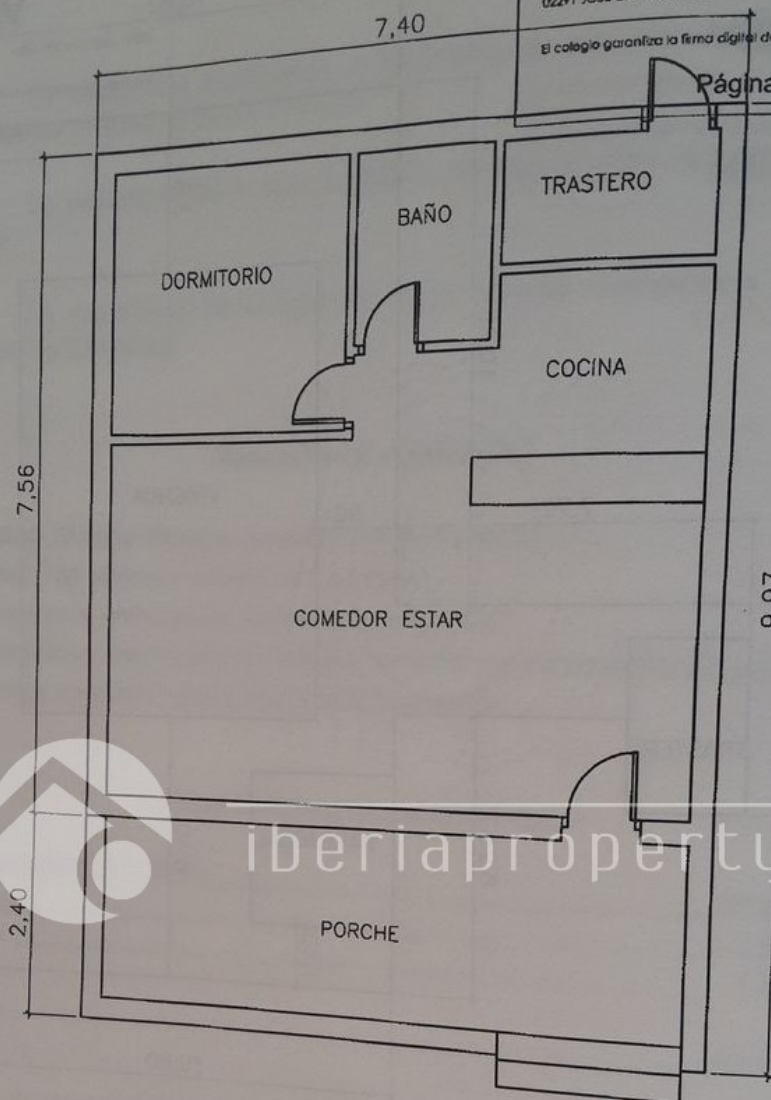

SUP. CONST. CERRADA= 55,94 M2  
 SUP. CONST. PORCHE= 17,90 M2/2=8,95 M2  
 SUP. CONSTRUIDA TOTAL= 64,89 M2

PROMOTOR	ESTEBAN TOME MORAL
PROYECTO	CERTIFICADO SUPERFICIES
SITUACION	PTDA. ALMARCH, POLG. 16, PCLA. 148, LA NUCIA, ALICANTE
PLANO	COTAS Y SUPERFICIES VIVIENDA
FECHA	AGOS 2010
EXP.	A10CER15
ESCALA	1:75
Nº PLANO	02

**OFITECNIC**  
ARQUITECTURA

OFITECNIC ARQUITECTURA S.L. Colg. 9036  
 ARQ. TEL. JOSE CHACON MESA Colg. 2291  
 C/Goya nº 1, 1º B, 03102 Benidorm, Alicante  
 Telf. y Fax: 96 585 5059 Movil: 689 592 964  
 www.ofitecnic.com / ofitecnic@ofitecnic.com