



REF: # 3932

COSTA MURCIA



#### INFO

PRICE:	169.900 €
PROPERTY TYPE:	Apartment
CITY:	Costa Murcia
BEDROOMS:	2
Bathrooms:	2
Build ( m2 ):	75
Plot ( m2 ):	-
Terrace ( m2 ):	75 + 24
Year:	2017
Floor:	2
Old price	-



#### DESCRIPTION

Fantastic beautiful apartments only 700 meters from the sandy beach of San Pedro del Pinatar and very short distance to several shops and restaurants. This is one of the best deals for a holiday in Spain. The apartment consists of 2 bedrooms and 2 bathrooms. Large and open living room with ultramodern kitchen. Several terraces. Private Terrace throughout 75m.2 and a large terrace of 24 m2 with access from both bedrooms. Walking distance to everything. Finished installing the outdoor kitchen on the roof terrace. It is only using building materials in very high quality. Security door, double windows very well insulated.

#### ENERGETIC CERTIFIED



<b>STYLE</b>	<b>AIRCONDITIONING</b>	<b>DISTANCE TO :</b>	<b>ORIENTATION</b>
<ul style="list-style-type: none"><li>• Modern</li></ul>	<ul style="list-style-type: none"><li>• Central airconditioning</li></ul>	Beach : 500 m Airport: 20 Km Town center : 200 m	South
<b>FURNITURE</b>	<b>PARKING</b>	<b>FLOORING</b>	<b>KITCHEN</b>
<ul style="list-style-type: none"><li>• Not furnished</li></ul>	Garage no Cars : 1 Parking no Cars: 1	<ul style="list-style-type: none"><li>• Tile floors</li></ul>	<ul style="list-style-type: none"><li>• Open kitchen</li><li>• Equipped kitchen</li></ul>
<b>GARDEN AND TERRACES</b>	<b>HEATING</b>	<b>EXTRA</b>	
<ul style="list-style-type: none"><li>• Covered terrace</li><li>• Open terrace</li><li>• Exterior lights</li><li>• Palm trees</li><li>• Fenced</li><li>• Stone walls</li><li>• Outdoor kitchen</li><li>• Communal Garden</li></ul>	<ul style="list-style-type: none"><li>• Central electric heating</li></ul>	<ul style="list-style-type: none"><li>• Built in wardrobes</li><li>• Double glazed windows</li><li>• Door bell with camera</li><li>• Laundry room</li><li>• Internet</li></ul>	



























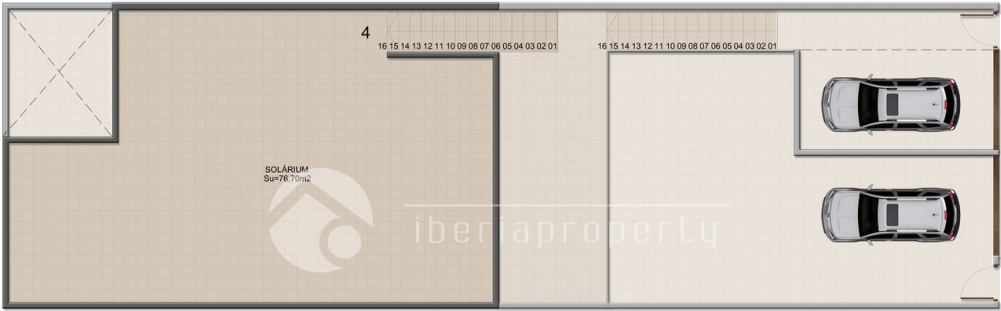

CUADRO DE SUPERFICIES				
Vivienda	Planta.	Uso.	S. Útil.	S. Const.
4	Primera.	Vivienda.	65.30 m2	75.42 m2
		Lavadero.	2.60 m2	2.60 m2
		Terraza.	23.95 m2	23.95 m2
		Solarium.	76.70 m2	76.70 m2
	Total m2.		168.55 m2	178.67 m2

VIVIENDA 4  
PLANTA PRIMERA  
ESCALA:1/75

PLAYAMAR III



#### CUADRO DE SUPERFICIES

Vivienda	Planta.	Uso.	S. Útil.	S. Const.
4	Primera.	Vivienda.	65.30 m²	75.42 m²
		Lavadero.	2.60 m²	2.60 m²
		Terraza.	23.95 m²	23.95 m²
		Solarium.	76.70 m²	76.70 m²
		Total m².	168.55 m²	178.67 m²

**VIVIENDA 4**  
**PLANTA PRIMERA**  
ESCALA:1/75

# PLAYAMAR III

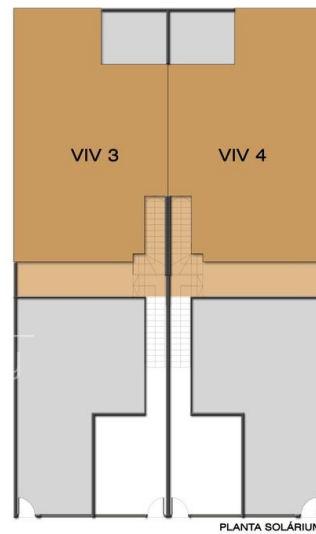
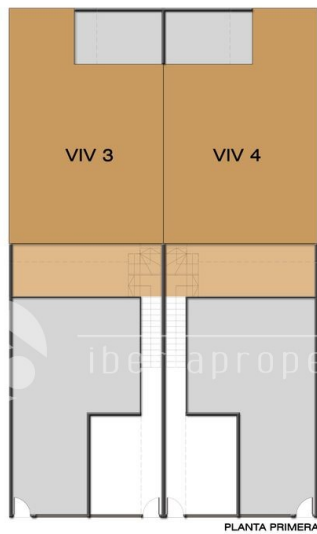
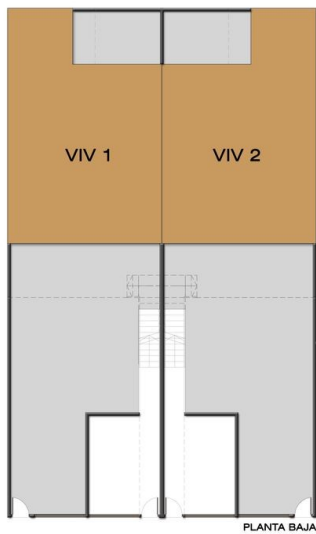

# PLAYAMAR III

"OUR EXPERIENCE IS YOUR GUARANTEE"