



REF: # 12130

ALICANTE (SANTA POLA)



INFO

PRICE:	411.500 €
PROPERTY TYPE:	Penthouse
CITY:	Alicante (Santa Pola)
BEDROOMS:	3
Bathrooms:	2
Build (m2):	164
Plot (m2):	-
Terrace (m2):	65
Year:	-
Floor:	-
Old price	-

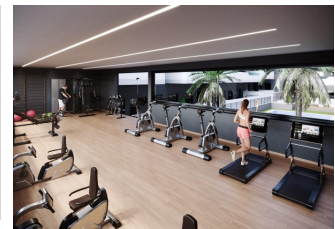

DESCRIPTION

NEW BUILD RESIDENTIAL COMPLEX IN SANTA POLA New Build modern gated residential complex consisting of 1, 2 and 3 bedroom apartments and penthouses with 2 complete bathrooms. The complex consists of 4 staircases of flats with spacious landscaped communal areas, including swimming pool, relaxation area and gymnasium. All properties have been carefully designed to provide you with an exceptional living experience, with high quality finishes and a modern style. Enjoy the spacious terraces, where you can relax, enjoy al fresco dining and watch the most spectacular sunsets. The location is simply unbeatable: next to the centre of Santa Pola and the palm grove, and only a few minutes from the promenade, you will be close to a wide range of restaurants, bars and supermarkets. Excellent connection with the national road 332, which connects all the southern Costa Blanca, and with the airport in only 15 minutes.

ENERGETIC CERTIFIED



VIEWS

- Panoramic views

AIRCONDITIONING

- Central airconditioning

MAIN LIVING AREA

- Gym

**GARDEN AND
TERRACES**

- Fenced

EXTRA

- Lift

PROPERTY GALLERY







PLANTA ÁTICO/ ESCALERA 1
VIVIENDA 4

	SUPERFICIE ÚTILES		SUPERFICIE CONSTRUIDAS	
			Cerrada	Abierta
VIVIENDA 4/ PÁTICO	Vestibulo	7.39	93.01	
	Salon-comedor-cocina	22.95	71.70	
	Dormitorio 1	16.40		
	Baño 1	3.68		
	Dormitorio 2	14.30		
	Baño 2	3.54		
	Dormitorio 3	11.73		
	Terraza	17.55		
	Solarium	48.55		
	TOTAL	146.09		164.71

Las superficies indicadas son con carácter informativo, no contractual y pueden sufrir ligeras variaciones por necesidades técnicas del proceso de construcción.

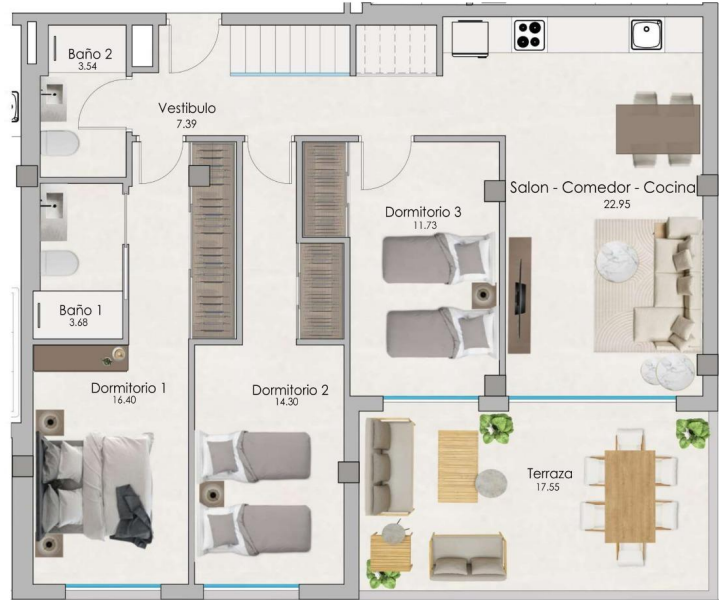

SOLARIUM / ESCALERA 1
VIVIENDA 4

VIVIENDA 4/ PATICO	SUPERFICIE UTILES		SUPERFICIE CONSTRUIDAS	
	Vestibulo	7.39	Cerrada	93.01
	Salon-comedor-cocina	22.95	Abierta	71.70
	Dormitorio 1	16.40		
	Baño 1	3.68		
	Dormitorio 2	14.30		
	Baño 2	3.54		
	Dormitorio 3	11.73		
	Terraza	17.55		
	Solarium	48.55		
	TOTAL	146.09		164.71

Las superficies indicadas lo son con carácter informativo, no contractual y pueden sufrir ligeras variaciones por necesidades técnicas del proceso de construcción.









"OUR EXPERIENCE IS YOUR GUARANTEE"