



REF: # 11783

TORREVIEJA



#### INFO

**PRICE:** 469.000 €

**PROPERTY TYPE:** Penthouse

**CITY:** Torrevieja

**BEDROOMS:** 2

**Bathrooms:** 2

**Build ( m2 ):** 64

**Plot ( m2 ):** -

**Terrace ( m2 ):** 26

**Year:** -

**Floor:** -

**Old price** -

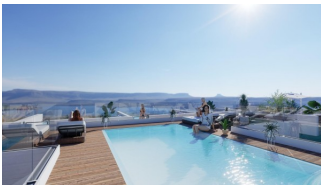

#### DESCRIPTION

**NEW BUILD PENTHOUSES IN TORREVIEJA** New Build avant-garde design five-storey development in Torrevieja with 34 exclusive properties offers a variety of living options, from stylish apartments to penthouses with breathtaking panoramic views. Every corner of residential has been carefully planned to maximise space and natural light, creating bright and welcoming environments that invite well-being. Residential majestically located in the heart of Torrevieja, consolidating itself as a residential development full of elegance and modernity. Its strategic location ensures that residents will feel part of this amazing city with easy access to a variety of services and attractions. It is a unique opportunity to invest in a sophisticated lifestyle in the heart of Torrevieja! Its unrivalled location, avant-garde design and meticulous attention to detail ensure that this residential development is much more than a place to live: it is a home where dreams take shape and life is lived to the fullest. Torrevieja is a Spanish town in the province of Alicante, on the Costa Blanca. It is known for its typically Mediterranean climate and coastline. It has boardwalks with resorts along its sandy beaches. The small Museum of the Sea and Salt houses exhibitions on the fishing and salt history of the city. In the interior, the Lagunas de La Mata-Torrevieja Natural Park has

trails and two salty lagoons, one pink and the other green. Alicante airport located 40 minutes away and Murcia airport about 1 hour away.



**VIEWS**

- Panoramic views

**AIRCONDITIONING**

- Central airconditioning

**PARKING**

Parking no Cars: 1

**EXTRA**

- Lift





























### Vivienda B - 2 Dormitorios

SUP. ÚTIL	(m²)
Hall - Distribuidor	9,70
Dormitorio 1	7,10
Baño 1	2,80
Dormitorio Suite	10,30
Baño Suite	2,70
Salón-Comedor-Cocina	21,00
<b>SUP. ÚTIL INTERIOR</b>	<b>53,60</b>
Terraza 1	9,90
<b>Solarium</b>	<b>16,60</b>
<b>SUP. CONST VIVIENDA</b>	<b>64,00</b>
<b>SUP. CONST TERRAZA</b>	<b>11,40</b>
<b>SUP. CONST SOLARIUM</b>	<b>16,60</b>
<b>SUP. CONST ZZCC</b>	<b>9,80</b>
<b>TOTAL VIVIENDA</b>	<b>101,80</b>

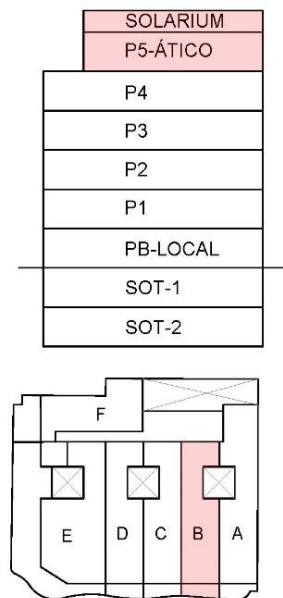
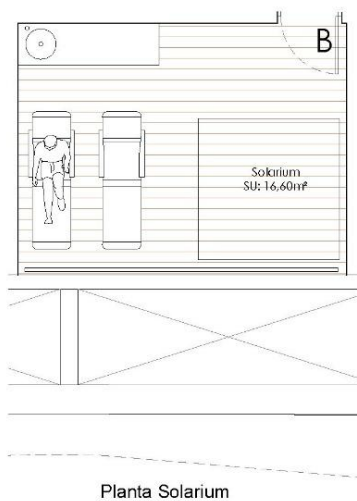













***"OUR EXPERIENCE IS YOUR GUARANTEE"***