



REF: # 11351

ORIHUELA COSTA



INFO

PRICE:	234.000 €
PROPERTY TYPE:	Penthouse
CITY:	Orihuela Costa
BEDROOMS:	2
Bathrooms:	1
Build (m2):	72
Plot (m2):	-
Terrace (m2):	-
Year:	-
Floor:	-
Old price	-



DESCRIPTION

NEW BUILD APARTMENTS IN LAS FILIPINAS New Build Residential complex in Las Filipinas. The gated community has a total of 94 apartments of 2 and 3 bedrooms and 1 or 2 bathrooms. Open plan kitchen with living room and terraces. The communal areas are roughly 3.300 m2 big and 2 pools, jacuzzi and 2 boules courts. W-Fi will be available in all communal areas. This residential located in the area of Villamartin Golf (Orihuela Costa), and is designed to fulfil the needs of those who are looking for the Mediterranean lifestyle, in a quiet area in a quiet but well established area and yet close to the sea (8 minutes) and very close to all amenities. Complex located 40 minutes from Alicante airport and 1 hour Murcia - Corvera airport.

ENERGETIC CERTIFIED



VIEWS

- Panoramic views

PROPERTY GALLERY













52	Piscina adultos	Adult pool	Piscina niños	76	Buñuelos	Berlos aux lettres
65	Piscina infantil	Children pool	Piscina niños	81	Sello apartamento	Parking rail
66	Entrada personal	Entrance	Entrée	82	Acceso personal a apartamento	Entrée personnelle au parking
67	Entrada apartamento	Parking entrance	Entrée parking	90	Duchas	Douche
74	Jacuzzi	Jacuzzi	Jacuzzi	114	Juegos piscina	Jeux piscine
76	Aparcamiento bici	Bike parking	Parking a vélos	121	Centro de transformación	Transformateur

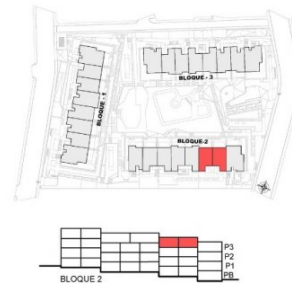

nº	SUPERFICIES ÚTILES / FLOOR AREA / SURFACES UTILES	TIPO / TYPE / TYPE
1	VESTIBULO / HALL / ENTRÉE	B3
2	DISTRIBUIDOR / CORRIDOR / CIRCULATION	1,58 m²
3	SALON-COMEDOR-COCINA / LIVING-DINING ROOM- KITCHEN /	1,19 m²
8	SALON SALLE A MANGER- CUISINE	26,82 m²
7	GALERIA / GALLERY / GALLERIE (LOBBY)	2,24 m²
9	DORMITORIO 1 / BEDROOM 1 / CHAMBRE 1	11,15 m²
10	DORMITORIO 2 / BEDROOM 2 / CHAMBRE 2	9,23 m²
12	BANO 1 / BATHROOM 1 / SALLE DE BAINS 1	5,47 m²
15	ESCALERA / STAIRS / ESCALIER	3,56 m²
TOTAL SUP. UTILES / TOTAL FLOOR AREA / TOTAL SURFACES UTILES		61,24 m²
SUP. CONSTRUIDA INTERIOR / BUILT INTERIOR AREA / SURFACE CONSTRUITE IN TIERIEUR		71,98 m²
22	SUP. CONSTRUIDA TERRAZA DESCUBERTA 1 / BUILT OPEN 1 AREA / SURFACE CONSTRuite TERRASSE DÉCOUVERTE	13,38 m²
20	SUP. CONSTRUIDA SOLARIUM 1 / BUILT SOLARIUM 1 AREA / SURFACE CONSTRuite SOLARIUM	43,08 m²
TOTAL SUP. CONSTRUIDA PRIVADA / TOTAL BUILT PRIVATE AREA / TOTAL SURFACE CONSTRuite PRIVATIVE		128,39 m²

TIPO/TYPE/TYPE B3

0 1 m 3 m 5 m







"OUR EXPERIENCE IS YOUR GUARANTEE"