



REF: # 6645

TORREVIEJA (TORREVIEJA)



#### INFO

PRICE:	159.900 €
PROPERTY TYPE:	Apartment
CITY:	Torrevieja (Torrevieja)
BEDROOMS:	2
Bathrooms:	2
Build ( m2 ):	72
Plot ( m2 ):	-
Terrace ( m2 ):	9
Year:	
Floor:	-
Old price	-

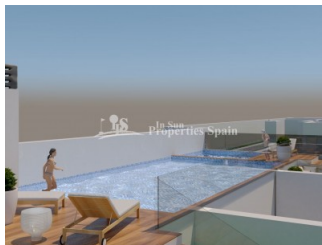

#### DESCRIPTION

Scandinavia is a new development of two or three-bedroom apartments only 50m from EL CURA BEACH, TORREVIEJA, the most famous beach in Torrevieja. This property comprises of two double bedrooms (both with fitted wardrobes), two bathrooms (en-suite to the master bedroom), modern fully-fitted integrated kitchen (with breakfast bar) and open-plan living/dining room, leading to a 9m2 terrace. Penthouse apartments also have a private solarium. There are storage rooms of 9m2-19m2 available from €12,000. The development benefits from a residents-only rooftop swimming pool and communal leisure area with barbecue. Delivery from April 2021. Scandinavia is located in Torrevieja town centre, just a few meters from the seafront with miles of beaches, bars, restaurants and cafes. Torrevieja was once a small fishing village and over the years became a large Cosmopolitan tow with marina, a wonderful promenade, a huge range of shops, fresh fish markets, night markets, water parks, and funfairs to name but a few. It's a great place to

sample some of the many fiestas held in Spain, such as the Semana Santa (Easter parade) the Three Kings (New Year parade), plus many more. From a relaxing stroll along the promenade, (a favorite with the Spanish), to water sports, boat/fishing trips, shopping or fine dining and for the more energetic a huge choice of bars and clubs that are open all night. This city has something for everyone.

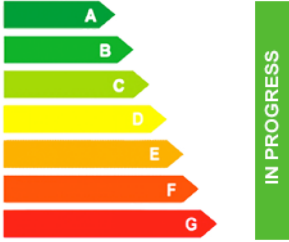

STYLE	DISTANCE TO :	ORIENTATION	FURNITURE
<ul style="list-style-type: none"> <li>Modern</li> <li>Contemporary</li> </ul>	Beach : 50 m Airport: 30 Km Town center : 100 m	South East West	<ul style="list-style-type: none"> <li>Not furnished</li> </ul>
MAIN LIVING AREA	FLOORING	KITCHEN	GARDEN AND TERRACES
<ul style="list-style-type: none"> <li>Storage</li> <li>Bathroom en-suite</li> </ul>	<ul style="list-style-type: none"> <li>Tile floors</li> <li>Stone floors</li> </ul>	<ul style="list-style-type: none"> <li>Open kitchen</li> <li>Equipped kitchen</li> </ul>	<ul style="list-style-type: none"> <li>Covered terrace</li> <li>Open terrace</li> <li>BBQ/grill</li> </ul>
EXTRA	ENERGETIC CERTIFIED		
<ul style="list-style-type: none"> <li>Reinforced door</li> <li>Double glazed windows</li> <li>Storage room</li> </ul>	 <p>The image shows a vertical energy efficiency scale with seven horizontal bars labeled A through G. Bar A is dark green, B is green, C is light green, D is yellow, E is orange, F is red-orange, and G is red. To the right of these bars is a vertical green bar with the text 'IN PROGRESS' written vertically inside it.</p>		

**"OUR EXPERIENCE IS YOUR GUARANTEE"**