

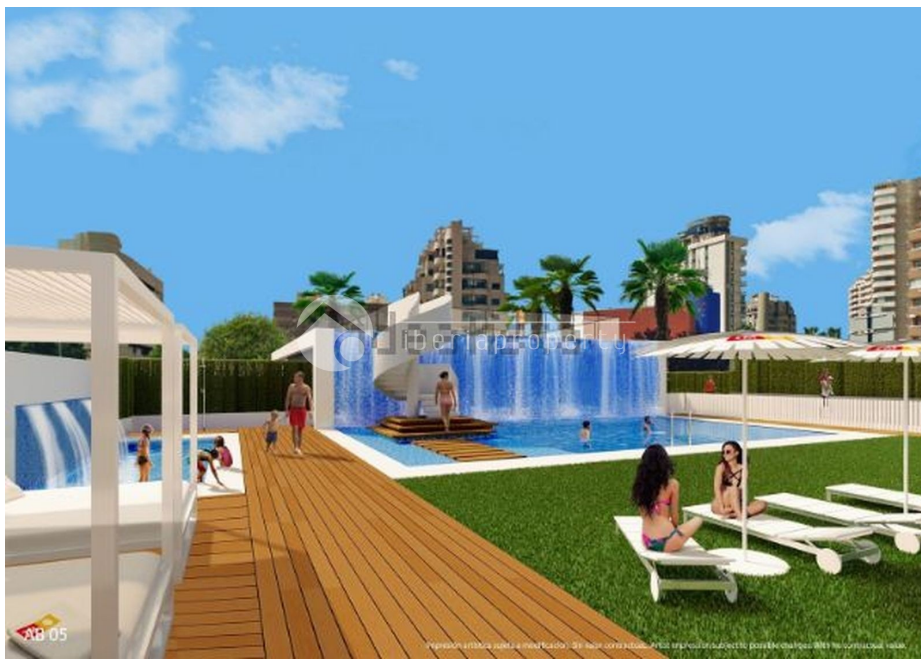

REF: # 4415

CALPE/MORAIRA (CALPE CENTRO)



INFO

PRICE:	220.000 €
PROPERTY TYPE:	Apartment
CITY:	Calpe/Moraira (Calpe centro)
BEDROOMS:	2
Bathrooms:	2
Build (m2):	103
Plot (m2):	-
Terrace (m2):	12
Year:	2018
Floor:	-
Old price	-

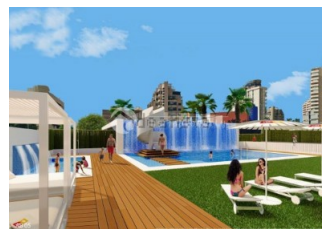
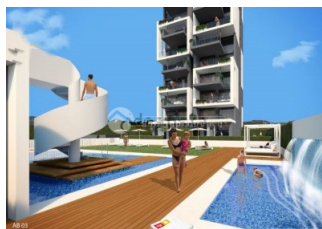

DESCRIPTION

Arenal Beach a unique residential complex that boasts impressive views of the sea and Peñon de Ifach. Here you will enjoy the sunshine and fresh sea air from your large terrace. The communal areas include a swimming pool for adults and another for children, as well as a poolside garden terrace complete with Balinese sun loungers and parasols. A spiral staircase leads you up a raised solarium, complete with Jacuzzi and lounge chairs, from which a water wall joins the swimming pool below creating a waterfall. Arenal Beach is in a privileged location in Calpe, an enchanting town where you can enjoy the authentic Mediterranean lifestyle and the chance to explore over 13 kilometers of coastline with stunning beaches and coves. The great majority of the homes have sea views. Depending on the height of the property you can also enjoy views of the swimming pools, the sea and Peñon de Ifach. Two bedroom apartments with large terraces from which you can enjoy the fresh air of the Mediterranean sea. Among its outstanding features are duct-type hold/cold air conditioning and underfloor heating in the

bathrooms. TM Real Estate Group gives you the possibility to personalise your home with a choice between a range of finishes, at no extra cost. So that you can start enjoying your home from day one, we give you the option to purchase it fully furnished with a choice of two furniture styles: Aktual or LGance. We will also arrange the water and electricity supply contracts for you. Each apartment comes included with a basement or outdoor parking space. The vibrant seafront promenade facing the residence offers a vast selection of services, including restaurants, cafes and ice cream shops. Calpe is a town bursting with Valencian culture, reflected in the Mudejar-Gothic architecture of its monuments, such as the church known as “Iglesia Vieja”, the castle and the archaeological site of the Medieval Town of Ifac. Within the vicinity of Arenal Beach you can also find schools, supermarkets, pharmacies and banks, among other local services. The Ifach Golf Club and Altea Golf Club are located just 20 minutes away by car from Arenal Beach. Both are strategically located between the sea and mountains, in natural surroundings of exceptional beauty."

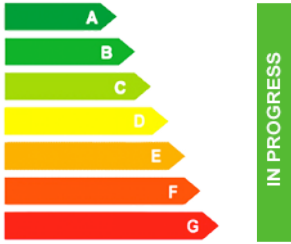

STYLE <ul style="list-style-type: none"> Modern 	AIRCONDITIONING <ul style="list-style-type: none"> Central airconditioning 	DISTANCE TO : <div>Beach : 200 m</div> <div>Airport: 60 Km</div> <div>Town center : 500 m</div>	ORIENTATION <div>South</div>
PARKING <div>Garage no Cars : 1</div> <div>Parking no Cars: 1</div>	MAIN LIVING AREA <ul style="list-style-type: none"> Bathroom en-suite 	FLOORING <ul style="list-style-type: none"> Tile floors 	KITCHEN <ul style="list-style-type: none"> Open kitchen Equipped kitchen
GARDEN AND TERRACES <ul style="list-style-type: none"> Open terrace Communal Garden 	EXTRA <ul style="list-style-type: none"> Reinforced door Double glazed windows Satellite TV Storage room Laundry room Lift Internet 	ENERGETIC CERTIFIED  <p>The image shows a vertical energy efficiency scale with seven horizontal bars labeled A through G. Bar A is dark green, B is green, C is light green, D is yellow, E is orange-yellow, F is orange, and G is red. To the right of these bars is a vertical green bar with the text 'IN PROGRESS' written vertically inside it.</p>	

"OUR EXPERIENCE IS YOUR GUARANTEE"