

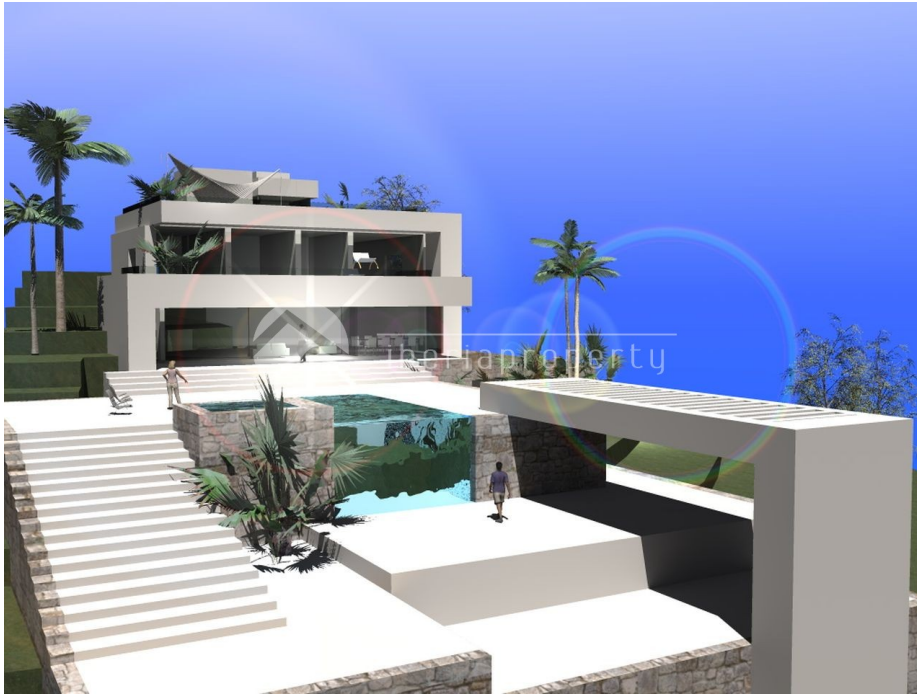

REF: # 4106

CALPE/MORAIRA (MORAIRA CENTRO)



INFO

PRICE:	REQUEST
PROPERTY TYPE:	Villa
CITY:	Calpe/Moraira (Moraira centro)
BEDROOMS:	3
Bathrooms:	4
Build (m2):	493
Plot (m2):	1.520
Terrace (m2):	-
Year:	2017
Floor:	3
Old price	-



DESCRIPTION

This modern project in the much sought after el Bosque, is distributed in basement, ground floor and first floor. On a plot of 1520 m2, The property benefits from its position, just 1 km. away from the center of Moraira-Teulada, and enjoys sea views and the bay of Moraira. The villa comprises 3 bedrooms with en-suite bathrooms. It will be built with materials of 1st quality and personalized customer. Additional features include; central heating, air conditioning system, double glazing security, barbecue, landscaped courtyards, the customer can choose to your liking, kitchen, flooring, interior-exterior color, etc .. This spectacular property enjoys an excellent location and offering everything necessary for a luxurious lifestyle.

ENERGETIC CERTIFIED



STYLE	VIEWS	AIRCONDITIONING	DISTANCE TO :
<ul style="list-style-type: none"> Modern 	<ul style="list-style-type: none"> Panoramic views Sea views Mountain views 	<ul style="list-style-type: none"> Central airconditioning 	Beach : 1 Km <hr/> Airport: 70 Km <hr/> Town center : 1 Km
ORIENTATION	FURNITURE	PARKING	MAIN LIVING AREA
South east <hr/>	<ul style="list-style-type: none"> Not furnished 	Garage no Cars : 2 <hr/> Parking no Cars: 3	<ul style="list-style-type: none"> Bathroom en-suite
FLOORING	KITCHEN	GARDEN AND TERRACES	HEATING
<ul style="list-style-type: none"> Tile floors 	<ul style="list-style-type: none"> Open kitchen Equipped kitchen Granite countertop 	<ul style="list-style-type: none"> Covered terrace Exterior lights Automatic watering system Fruit trees Palm trees Landscaped Fenced Stone walls Electric gate Outdoor kitchen BBQ/grill 	<ul style="list-style-type: none"> Floor heating Floor heating bathrooms Fireplace gas
EXTRA	ENERGETIC CERTIFIED		
<ul style="list-style-type: none"> Outdoor jacuzzi Built in wardrobes Alarm Reinforced door Double glazed windows Satellite TV Video security Storage room Laundry room Lift Internet 	 <p>The image shows a vertical energy efficiency scale with seven horizontal bars labeled A through G. The bars are colored in a gradient from green at the top to red at the bottom. To the right of the scale is a vertical green bar with the text 'IN PROGRESS' written vertically inside it.</p>		

"OUR EXPERIENCE IS YOUR GUARANTEE"