



REF: # 3553

CALPE/MORAIRA (MORAIRA)



#### INFO

PRICE:	492.000 €
PROPERTY TYPE:	Villa
CITY:	Calpe/Moraira (Moraira)
BEDROOMS:	3
Bathrooms:	3
Build ( m2 ):	185
Plot ( m2 ):	815
Terrace ( m2 ):	-
Year:	2016
Floor:	2
Old price	-

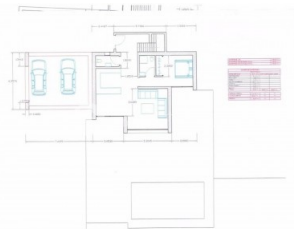

#### DESCRIPTION

The project includes a 815m2 plot, with a gentle slope, with the advantage of constructing an elegant villa, including raising the pool area, terrace and storage. The project includes a 8x4m swimming pool. The Building Specifications for this project are available on request. The property will be constructed using top quality materials and always according to current building standards and with the required licenses. We have other plots and villa designs available and should the client have other preferences and requirements, This plot is located in one of the most sought after areas of Moraira, in Arnella. The beautiful beach of El Portet is about 2km away and the lovely village of Moraira and its private marina about 3.5km. Moraira boasts all shops and services, including all types of businesses, banks, boutiques, bars and international restaurants with exquisite cuisine and importantly a health centre. The plot is south east facing with nice views, the views can be appreciated once the plot has been cleared.

#### ENERGETIC CERTIFIED



<b>STYLE</b> <ul style="list-style-type: none"> <li>Modern</li> </ul>	<b>VIEWS</b> <ul style="list-style-type: none"> <li>Panoramic views</li> <li>Mountain views</li> </ul>	<b>AIRCONDITIONING</b> <ul style="list-style-type: none"> <li>Livingroom</li> <li>Kitchen</li> <li>Bedrooms</li> </ul>	<b>DISTANCE TO :</b> <div>Beach : 2 Km</div> <div>Airport: 80 Km</div> <div>Town center : 3 Km</div>
<b>ORIENTATION</b> <div>South east</div>	<b>FURNITURE</b> <ul style="list-style-type: none"> <li>Not furnished</li> </ul>	<b>PARKING</b> <div>Parking no Cars: 2</div>	<b>MAIN LIVING AREA</b> <ul style="list-style-type: none"> <li>Storage</li> <li>Bathroom en-suite</li> </ul>
<b>FLOORING</b> <ul style="list-style-type: none"> <li>Tile floors</li> </ul>	<b>KITCHEN</b> <ul style="list-style-type: none"> <li>Open kitchen</li> <li>Equipped kitchen</li> <li>Granite countertop</li> </ul>	<b>GARDEN AND TERRACES</b> <ul style="list-style-type: none"> <li>Covered terrace</li> <li>Open terrace</li> <li>Exterior lights</li> <li>Palm trees</li> <li>Landscaped</li> <li>Fenced</li> <li>Stone walls</li> <li>Electric gate</li> </ul>	<b>HEATING</b> <ul style="list-style-type: none"> <li>Floor heating</li> <li>Floor heating bathrooms</li> <li>Fireplace gas</li> </ul>
<b>EXTRA</b> <ul style="list-style-type: none"> <li>Built in wardrobes</li> <li>Alarm</li> <li>Reinforced door</li> <li>Double glazed windows</li> <li>Door bell with camera</li> <li>Video security</li> <li>Storage room</li> <li>Laundry room</li> <li>Internet</li> </ul>	<b>ENERGETIC CERTIFIED</b> 		

"OUR EXPERIENCE IS YOUR GUARANTEE"