



REF: # 7877

BENIDORM (PLAYA PONIENTE)



INFO

PRICE: 188.000 €

PROPERTY TYPE: Apartment

CITY: Benidorm (Playa Poniente)

BEDROOMS: 1

Bathrooms: 1

Build (m2): 54

Plot (m2): -

Terrace (m2): 15

Year:

Floor: 100

Old price -



DESCRIPTION

New 13 story building situated in the quiet part of Benidorm. Southfacing spaciou terrace with seaview only 200m from Poniente Beach. On the 4000m2 land there is chill out places, pool and padle tennis. The apartment is very open with a lot of light. High technical standard. Both livingroom and bedroom have direct acces to the terrace From Playa Poniente you have easy access to Puig Campana mountain, 1362 m high fantastic for haiking/cycling, Asia Garden Hotel, 3 golf courses, Villa Aitana Hotel, Terra Mitica Theme Park and more. The Avenue is connected directly to the exit of the AP-7 La Marina, Crossroads, Leroy Merlin, Mercadona, Decathlon, Zara etc. And next to this all the services of the most powerful tourist center of the Costa Blanca Due to the proximity to the coast you can enjoy the fabulous beaches of Levante, Poniente, the Cala de Finestrat and the Villajoyosa and Calpe with more than 13 km in length that are among the best in Europe awarded the European Union blue flag awarded by the quality of its waters, by cleaning and services offered.

ENERGETIC CERTIFIED



STYLE	VIEWS	AIRCONDITIONING	DISTANCE TO :
<ul style="list-style-type: none">• Modern	<ul style="list-style-type: none">• Panoramic views• Sea views• Mountain views	<ul style="list-style-type: none">• Central airconditioning	Beach : 200 m
			Airport: 60 Km
			Town center : 100 m
ORIENTATION	FURNITURE	PARKING	MAIN LIVING AREA
South	<ul style="list-style-type: none">• Not furnished	Garage no Cars : 1	<ul style="list-style-type: none">• Gym
FLOORING	KITCHEN	GARDEN AND TERRACES	HEATING
<ul style="list-style-type: none">• Tile floors	<ul style="list-style-type: none">• Open kitchen• Equipped kitchen• Granite countertop	<ul style="list-style-type: none">• Covered terrace• Exterior lights• Automatic watering system• Palm trees• Play Ground• Landscaped• Fenced• Lawn• Stone walls• Electric gate• Outdoor kitchen• BBQ/grill• Padle tennis• Communal Garden	<ul style="list-style-type: none">• Floor heating bathrooms
EXTRA			
<ul style="list-style-type: none">• Built in wardrobes• Reinforced door• Double glazed windows• Door bell with camera• Satellite TV• Laundry room• Lift• Internet• Concierge			





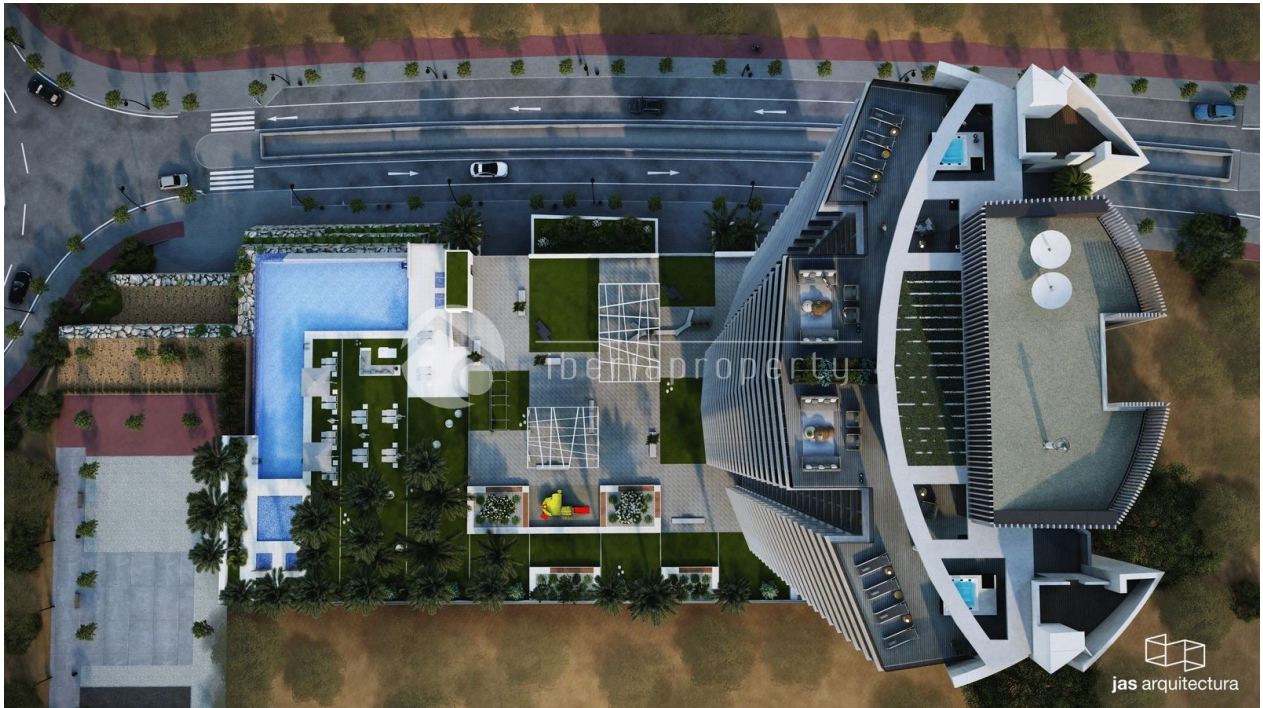













"OUR EXPERIENCE IS YOUR GUARANTEE"