



REF: # 7318

FINESTRAT (FINESTRAT HILLS)



INFO

PRICE:	225.000 €
PROPERTY TYPE:	Apartment (Penthouse)
CITY:	Finestrat (Finestrat Hills)
BEDROOMS:	2
Bathrooms:	2
Build (m2):	69
Plot (m2):	-
Terrace (m2):	68 -17
Year:	
Floor:	2
Old price	-

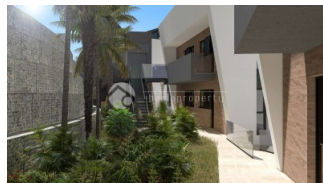

DESCRIPTION

16 NEW APARTMENTS DIVIDED ON 3 BLOCKS - ALL WITH GREAT VIEWS IN FINESTRAT HILLS CAMPAIGN: ALL APPLIANCES ARE INCLUDED Apartment on the second floor comprises 2 bedrooms and 2 bathrooms open plan living room kitchen solution, terrace of 17 sqm plus a private roof terrace of 68m2. Fully equipped kitchen with quarts worktop, steel sink, hob, kitchen fan. Bathroom decoration with mirror and light. Shower enclosures. Built-in wardrobe. TV telephone and internet outlets in the living room, on the terrace and in all bedrooms. Electric blinds in the bedrooms Heating cables in all bathrooms. Pre-installation of air conditioning / heat pump, with balanced ventilation in all rooms. Airothermia for production of tap water / hot water. Anti-slip tiles on all terraces. Outdoor area with communal pool green area. A 10-year guarantee is given for hidden defects and faults.

ENERGETIC CERTIFIED



STYLE	VIEWS	AIRCONDITIONING	DISTANCE TO :
<ul style="list-style-type: none">• Modern	<ul style="list-style-type: none">• Panoramic views• Sea views• Mountain views	<ul style="list-style-type: none">• Central airconditioning	Beach : 4 Km <hr/> Airport: 40 Km <hr/> Town center : 2 Km
ORIENTATION	MAIN LIVING AREA	FLOORING	KITCHEN
South	<ul style="list-style-type: none">• Bathroom en-suite	<ul style="list-style-type: none">• Tile floors	<ul style="list-style-type: none">• Open kitchen• Equipped kitchen
GARDEN AND TERRACES	HEATING	EXTRA	
<ul style="list-style-type: none">• Covered terrace• Open terrace• Exterior lights• Automatic watering system• Palm trees• Landscaped• Communal Garden	<ul style="list-style-type: none">• Floor heating bathrooms	<ul style="list-style-type: none">• Built in wardrobes• Reinforced door• Double glazed windows• Internet	





BALCÓN DE FINESTRAT

16 VIVIENDAS + PISCINAS + APARCAMIENTO



BALCÓN DE FINESTRAT

16 VIVIENDAS + PISCINAS + APARCAMIENTO







iberiaproperty



iberiaproperty

BALCÓN DE FINESTRAT

16 VIVIENDAS + PISCINAS + APARCAMIENTO

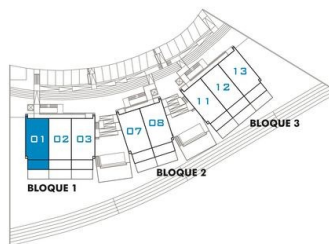

BLOQUE 1 - VIVIENDA 01

SUP. CONSTRUIDA VIVIENDA (PORCHE CUBIERTO 50%) 79.50 m²
m² TERRAZA DESCUBIERTA 27.00 m²

m² TOTALES 106.50 m²

m² PARCELA PRIVATIVA 56.00 m²



PLANTA BAJA (1/75) DIN A3



PARCELA PRIVATIVA (1/75)

BALCÓN DE FINESTRAT

16 VIVIENDAS + PISCINAS + APARCAMIENTO

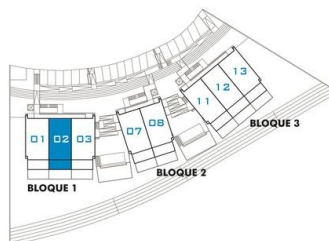

BLOQUE 1 - VIVIENDA 02

SUP. CONSTRUIDA VIVIENDA (PORCHE CUBIERTO 50%) 77.80 m²
m² TERRAZA DESCUBIERTA 27.00 m²

m² TOTALES 104.80 m²

m² PARCELA PRIVATIVA 56.00 m²



PLANTA BAJA (1/75) DIN A3



PARCELA PRIVATIVA (1/75)

BALCÓN DE FINESTRAT

16 VIVIENDAS + PISCINAS + APARCAMIENTO

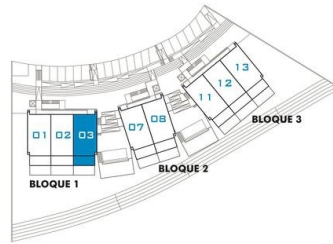

BLOQUE 1 - VIVIENDA 03

SUP. CONSTRUIDA VIVIENDA (PORCHE CUBIERTO 50%) 79.50 m²
m² TERRAZA DESCUBIERTA 27.00 m²

m² TOTALES 106.50 m²

m² PARCELA PRIVATIVA 56.00 m²



PLANTA BAJA (1/75) DIN A3

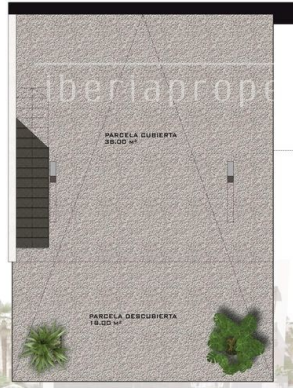

PARCELA PRIVATIVA (1/75)

BALCÓN DE FINESTRAT

16 VIVIENDAS + PISCINAS + APARCAMIENTO

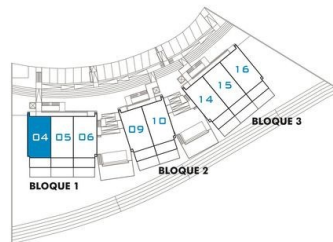

BLOQUE 1 - VIVIENDA 04

SUP. CONSTRUIDA VIVIENDA 71.20 m²
m² TERRAZAS 17.50 m²

m² TOTALES 88.70 m²

m² SOLARIUM 68.00 m²



PLANTA PISO (1/75) DIN A3



SOLARIUM (1/75)

BALCÓN DE FINESTRAT

16 VIVIENDAS + PISCINAS + APARCAMIENTO

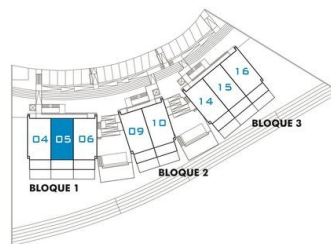

BLOQUE 1 - VIVIENDA 05

SUR. CONSTRUIDA VIVIENDA 69.30 m²
m² TERRAZAS 17.50 m²

m² TOTALES 86.80 m²

m² SOLARIUM 68.00 m²



PLANTA PISO (1/75) DIN A3



SOLARIUM (1/75)



BALCÓN DE FINESTRAT

16 VIVIENDAS + PISCINAS + APARCAMIENTO

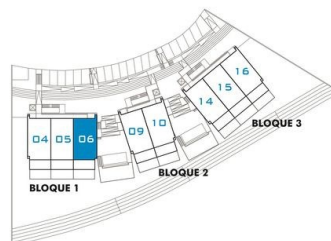

BLOQUE 1 - VIVIENDA 06

SUR. CONSTRUIDA VIVIENDA 71.20 m²
m² TERRAZAS 17.50 m²

m² TOTALES 88.70 m²

m² SOLARIUM 68.00 m²



PLANTA PISO (1/75) DIN A3



SOLARIUM (1/75)



"OUR EXPERIENCE IS YOUR GUARANTEE"