



REF: # 4289

TORREVIEJA (LA SIESTA - SAN LUIS)



INFO

PRICE:	358.000 €
PROPERTY TYPE:	Villa
CITY:	Torrevieja (La Siesta - San Luis)
BEDROOMS:	3
Bathrooms:	2
Build (m2):	177
Plot (m2):	400
Terrace (m2):	-
Year:	2018
Floor:	-
Old price	-



DESCRIPTION

A new project comprising of 4 Luxury Villas with modern design and large south facing plots on 400m2 each located in La Siesta - Torrevieja . The villas are distributed on one floor only and comprises of 3 bedrooms, 2 bathrooms (1 bathroom is en-suite), spacious living room, modern open plan kitchen and a laundry room. From the living room there is direct access through big sliding doors to the terrace and to the private pool which is optional and that measures 3,5 x 7 meters. The villas will be finished to the highest standards, and are delivered with integrated wardrobes in the bedrooms, marble worktop (Silestone) in the kitchen, heated floors in the bathrooms, electric blinds, pre-installation of central air condition and home automation center and off-road parking. As an extra you can also have a large roof top solarium with nice views and sun all day . Walking distance to shops and restaurants. La Siesta is located just a few minutes from the best beaches of Torrevieja the Habaneras

Shopping Center and close to 4 of the best golf courses in the area. Only 20 min. drive from San Javier airport and 40 min. to Alicante airport. Pool 3,5x7 = 12.000€ Solarium - Roof Terrace = 12.000€



STYLE <ul style="list-style-type: none">• Modern• Contemporary	VIEWS <ul style="list-style-type: none">• Panoramic views	AIRCONDITIONING <ul style="list-style-type: none">• Central airconditioning	DISTANCE TO : <div>Beach : 4 Km</div> <div>Airport: 40 Km</div> <div>Town center : 1 Km</div>
ORIENTATION <div>South west</div>	FURNITURE <ul style="list-style-type: none">• Not furnished	PARKING <div>Parking no Cars: 1</div>	MAIN LIVING AREA <ul style="list-style-type: none">• Storage• Bathroom en-suite
FLOORING <ul style="list-style-type: none">• Tile floors• Stone floors	KITCHEN <ul style="list-style-type: none">• Open kitchen• Equipped kitchen• Granite countertop	GARDEN AND TERRACES <ul style="list-style-type: none">• Covered terrace• Open terrace• Automatic watering system• Landscaped• Fenced• Stone walls• Private garden	HEATING <ul style="list-style-type: none">• Floor heating bathrooms
EXTRA <ul style="list-style-type: none">• Built in wardrobes• Double glazed windows			





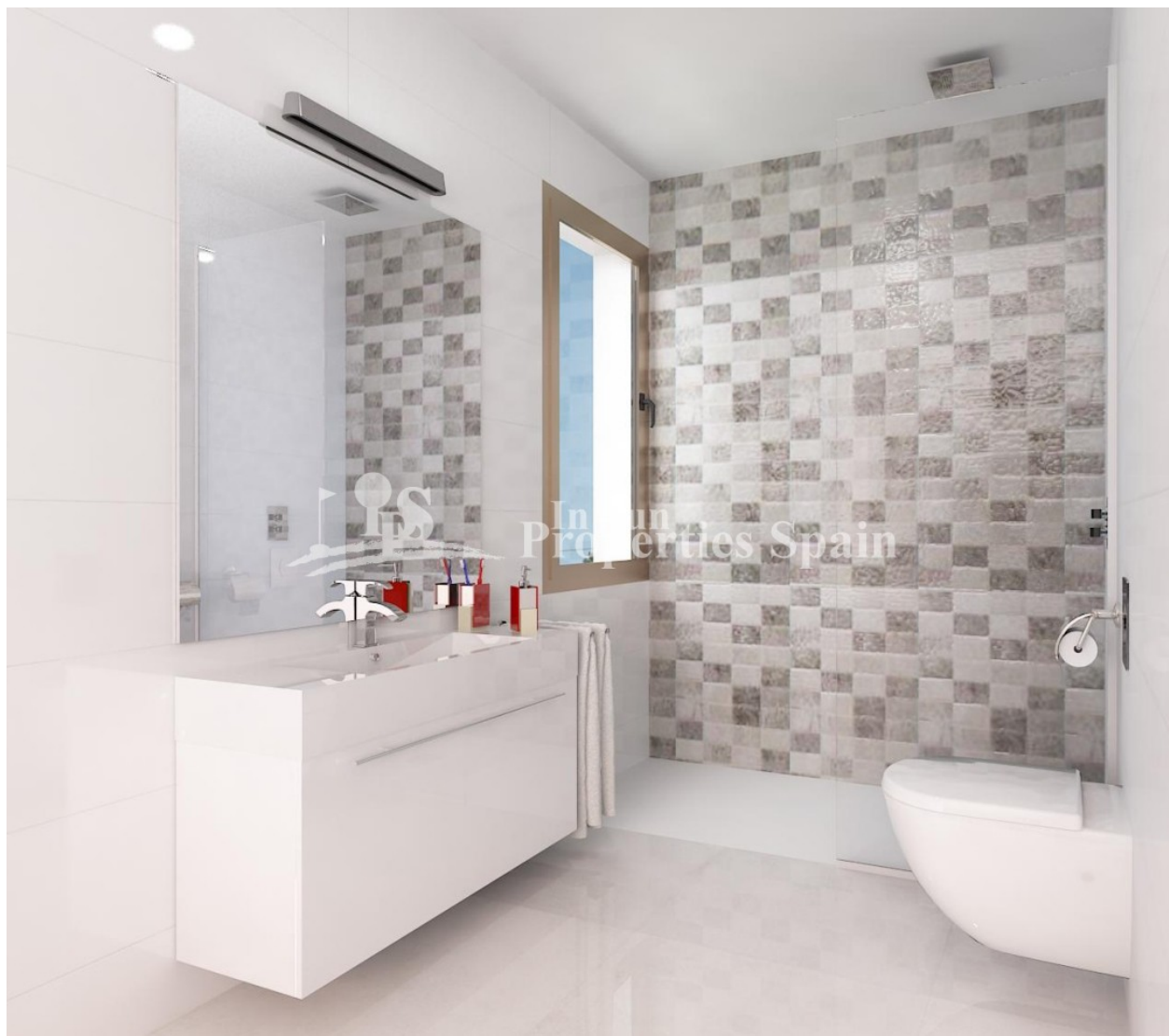



CUADRO DE SUPERFICIES	
DENOMINACION.	SUPERFICIE.
HALL	4.96
ESTAR-COMEDOR-COCINA	34.37
GALERÍA (50%)	0.37
DORMITORIO 1	13.76
DORMITORIO 2	12.29
DORMITORIO 3	10.40
BAÑO 1	4.05
BAÑO 2	3.90
PASILLO	4.38
PORCHE (50%)	8.79
TOTAL SUP. UTIL VIVIENDA	97.27 m2
TOTAL SUP. CONS. VIVIENDA	115.27 m2

SUPEFICIE TOTAL: 177 m²

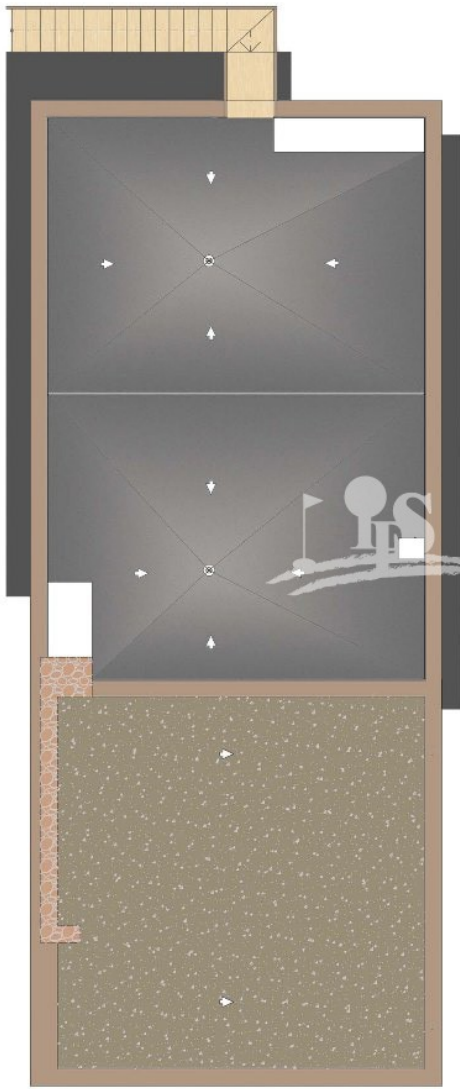

SUPEFICIE TOTAL: 177 m²

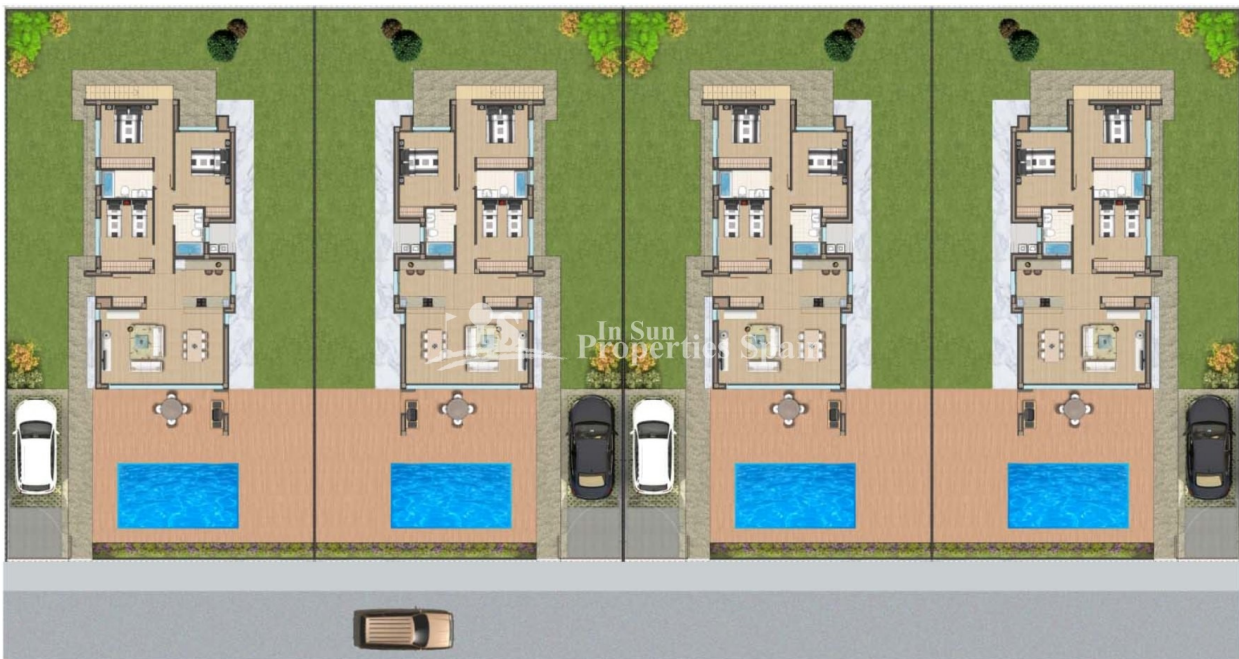







"OUR EXPERIENCE IS YOUR GUARANTEE"